

METAL CASE HYPASS™ INTERFERENCE SUPPRESSION POLYESTER FILM CAPACITORS

TYPE 409P

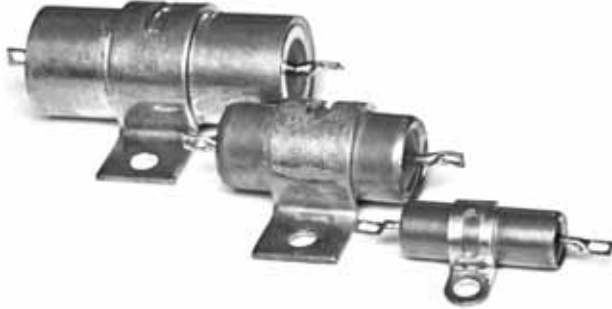

FEATURES

- High frequency filtering
- No series resonance
- Low inductance to ground

MAJOR APPLICATIONS: EMI suppression.

PHYSICAL CHARACTERISTICS

TORQUE: Terminals shall withstand 10 inch pounds with no damage.

DIMENSIONS: See chart below, contact factory for additional sizes.

MARKING:

Dearborn trademark, type or catalog number, capacitance, and voltage.

ENVIRONMENTAL CHARACTERISTICS

DC LIFE TEST:

- 150% of rated DC voltage for 250 hours at +85°C.
- No open or short circuits.
- No visible damage: Max. Cap chg: ±5%
Min. I.R. = 50% of initial limit
Max. D.F. = 2.0%

THERMAL SHOCK AND IMMERSION CYCLING:

No visible damage: Max. Cap chg: ±5%
Min. I.R. = 50% of initial limit
Max. D.F. = 2.0%

ELECTRICAL SPECIFICATIONS

CAPACITANCE RANGE: 0.10 µF to 0.5 µF

DC VOLTAGE RATING: 50 VDC to 1,000 VDC

CAPACITANCE TOLERANCE: +20% - 10%, ±10%

OPERATING TEMPERATURE: -40°C to +85°C

DISSIPATION FACTOR: 1.0% maximum

VOLTAGE TEST: 200% of rated voltage for 1 minute

INSULATION RESISTANCE:

- At +25°C, 20,000 Megaohm-Microfarads, need not exceed 20,000 Megaohms
- At +85°C, 200 Megaohm-Microfarads, need not exceed 1,000 Megaohms

TYPICAL SIZES

Current µF in Amps	Bracket mounting Dimensions						Fig.	
	D	L	W	M	R	Y		
50 WVDC								
0.50	40	1.000	1.813	1.000	0.875	1.188	0.250	1
0.50	60	1.000	1.813	1.000	0.875	1.188	0.250	1
200 WVDC								
0.25	20	0.750	1.813	0.750	0.656	0.875	0.201	1
0.50	20	1.000	1.813	1.000	0.875	1.188	0.250	1
400 WVDC								
0.10	20	0.688	1.813	0.750	0.641	0.781	0.201	1
600 WVDC								
0.10	20	0.688	1.813	0.750	0.641	0.781	0.201	1
0.25	20	1.000	1.813	1.000	0.875	1.188	0.250	1
0.50	20	1.000	2.250	1.000	0.875	1.188	0.250	1

Current µF in Amps	Bulkhead mounting Dimensions						Fig.	
	D	L	W	M	R	Y		
200 WVDC								
0.25	20	0.750	1.813	0.875	1.125	1.438	0.156	2
400 WVDC								
0.10	20	0.688	1.813	0.875	1.062	1.375	0.156	2
600 WVDC								
0.10	20	0.688	1.813	0.875	1.062	1.375	0.156	2
0.50	100	1.125	3.125	1.500	1.750	2.312	0.201	3
1,000 WVDC								
0.20	100	1.125	3.125	1.500	1.750	2.312	0.201	3

Note:

Hypass capacitors rated at 200 WVDC or 400 WVDC may be used on 130 volt, 60Hz circuits. Capacitors rated at 600 and 1,000 WVDC may be used on 250 volt, 60Hz circuits.

INSERTION LOSS OF A HYPASS™ CAPACITOR VS. A CONVENTIONAL CAPACITOR

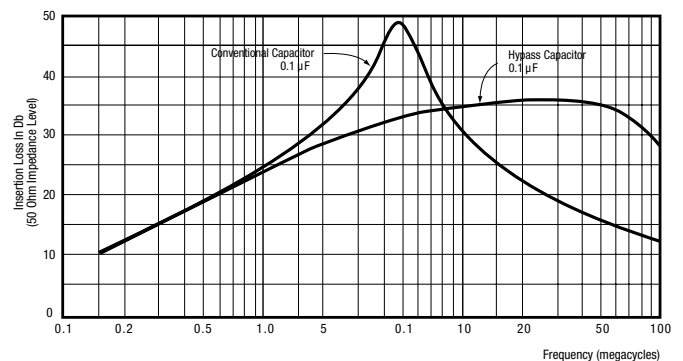

METAL CASE HYPASST™ INTERFERENCE SUPPRESSION POLYESTER FILM CAPACITORS

FIGURE 1

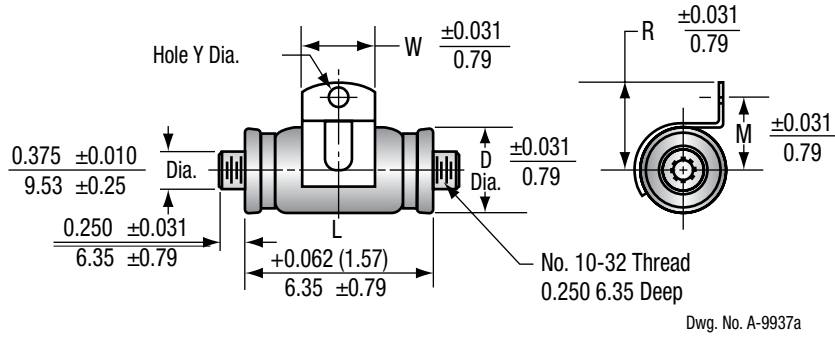

FIGURE 2

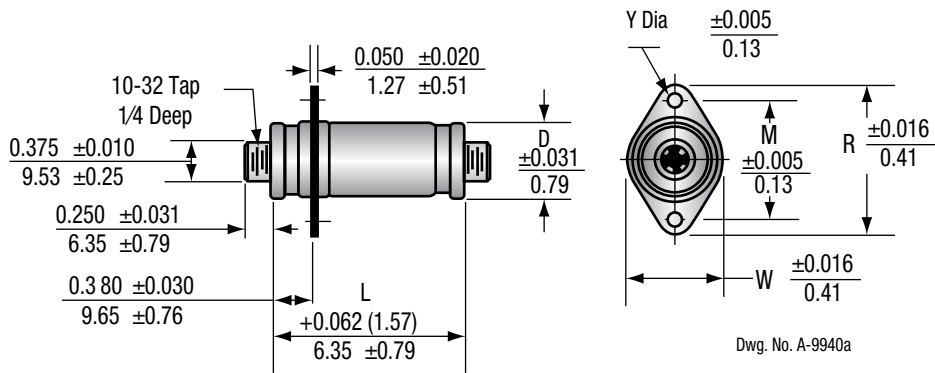
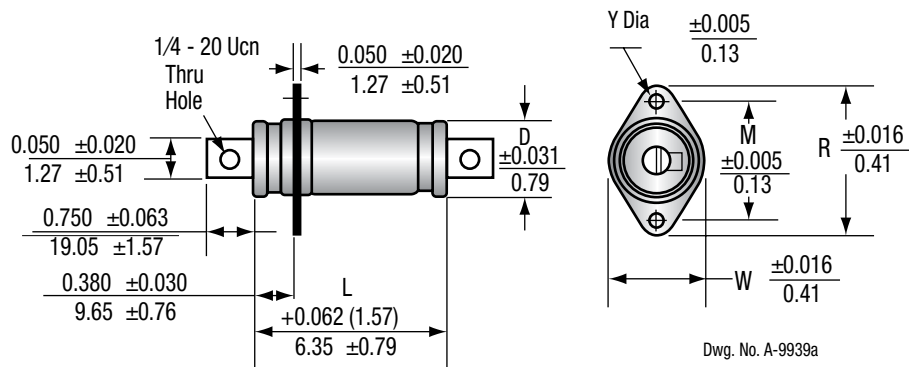

FIGURE 3



Dimensions: $\frac{\text{Inches}}{\text{Millimeters}}$

Terminal Hardware Available On Special Order.